



**152-160 Maroondah Highway Croydon VIC**

- ? Building & Yard Available
- ? 1160sqm or 12481ft2 of Land Area
- ? 144sqm or 1550ft2 approx of Building Area
- ? Commercial 1 Zoning
- ? Heating and Cooling
- ? Toilet & Kitchenette Facilites

Contact Brad Knight today for more information or to arrange an Inspection on 0427 301 538.

**Type** : Industrial  
**Building Size** : 144 sqm  
**Land Size** : 1160 sqm  
**View** : <https://www.nobleknight.com.au/sale/vic/east/croydon/commercial/industrial/8570982>



**Brad Knight**  
**03 9730 1788**

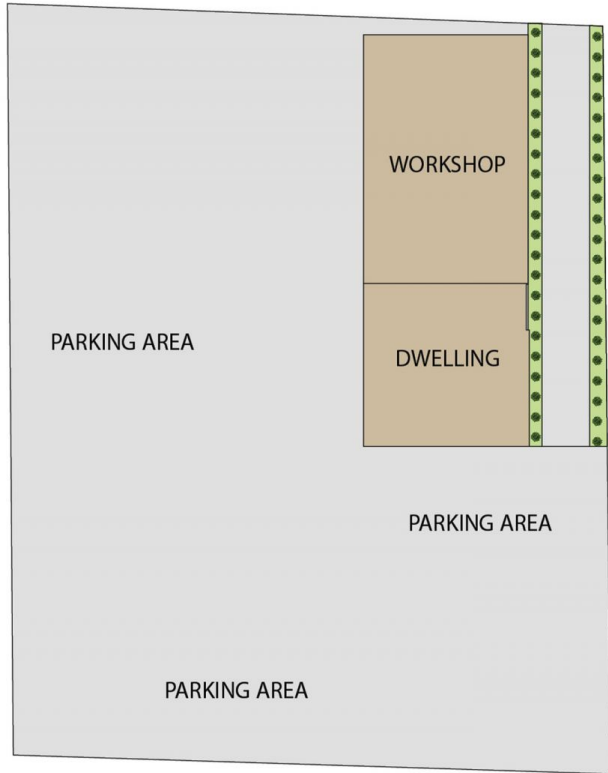
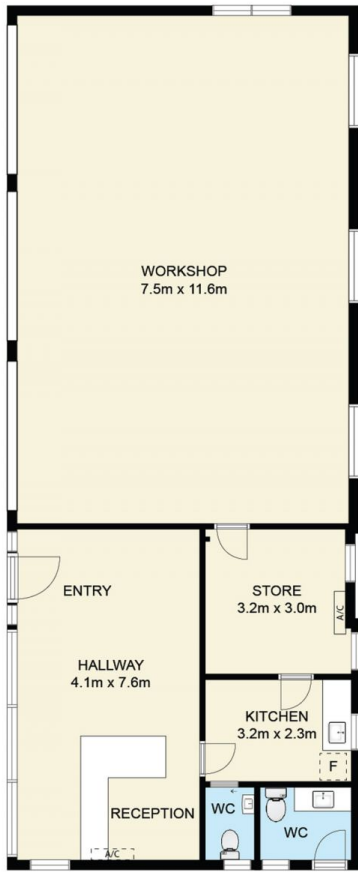

152 Maroondah Hwy, Croydon, VIC, 3136

TOTAL APPROX. FLOOR AREA 136 SQM

Whilst every attempt has been made to ensure the accuracy of the floor plan contained here, measurements of doors, windows, rooms and any other items are approximate and no responsibility is taken for any error, omission, or misstatement. This plan is for illustrative purposes only and should be used as such by any prospective purchaser.