



### 176 Main Street Lilydale VIC

- ? 100sqm or 1076ft2 approx
- ? Rear Access with Ample Parking
- ? Commercial 1 Zone
- ? Three Year Lease Commencing 1st October 2025
- ? Start Your Investment Portfolio Here

Contact Brad Knight on 0427 301 538 for an inspection today  
 Shop 176 Main Street, Lilydale, Victoria, 3140.

**Type** : Retail  
**Building Size** : 100 sqm  
**View** : <https://www.nobleknight.com.au/sale/vic/east/lilydale/commercial/retail/8491638>



**Brad Knight**  
 03 9730 1788

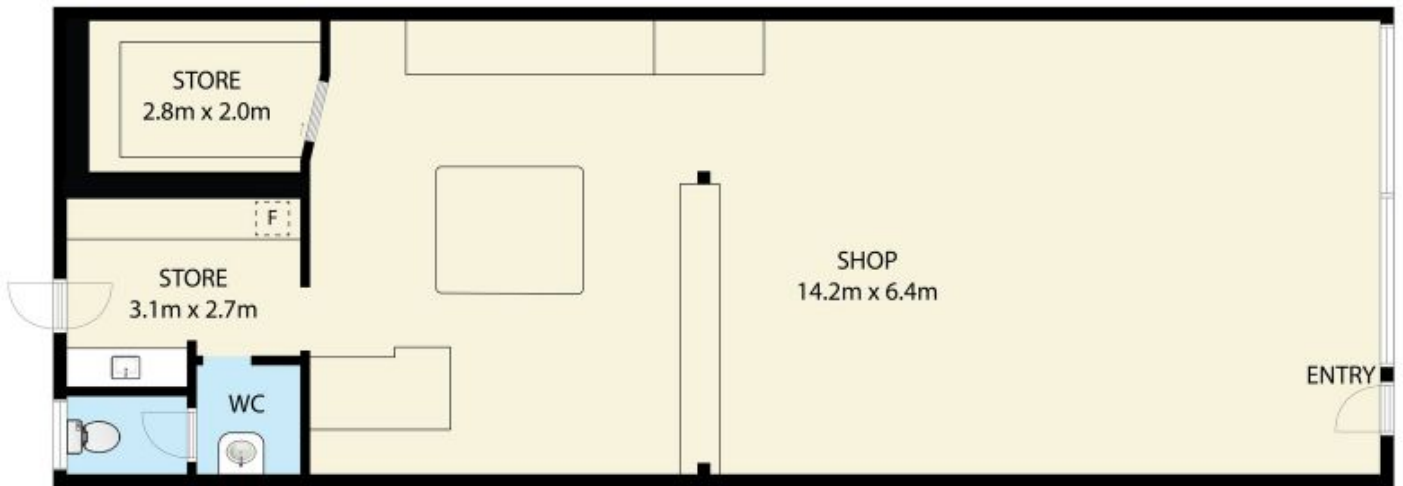

176 Main Street, Lilydale, VIC, 3140

TOTAL APPROX. FLOOR AREA 105 SQ.M

Whilst every attempt has been made to ensure the accuracy of the floor plan contained here, measurements of doors, windows, rooms and any other items are approximate and no responsibility is taken for any error, omission, or misstatement. This plan is for illustrative purposes only and should be used as such by any prospective purchaser.

