



## 5 Gilba Place Lilydale VIC

4 2 2

Nestled in the tranquil enclave of Lilydale, this split-level home draws inspiration from Tuscan aesthetics, offering a serene retreat. Constructed in 1986 on approximately 1.58 acres, this meticulously crafted residence seamlessly combines sophistication and practicality, ensuring an exceptional living experience for you and your loved ones.

Upon entry, natural light floods the interior, highlighting the picturesque vista of the dam and Lilydale beyond. The layout effortlessly connects living spaces, fostering an ideal ambiance for both relaxation and entertainment. Comprising four bedrooms, two bathrooms, and three living areas, this spacious abode also includes a kitchen with a walk-in pantry, a double carport, garden shed, under-house workshop, and storage facilities.

Additional comforts include a ducted vacuum system and

**Price** : \$1,600,000 - \$1,700,000  
**Land Size** : 6394 sqm  
**View** : <https://www.nobleknight.com.au/sale/vic/east/lilydale/residential/house/7953414>



**Damian Ford**  
03 9735 5677



**Megan Tiberi**  
03 9730 1788

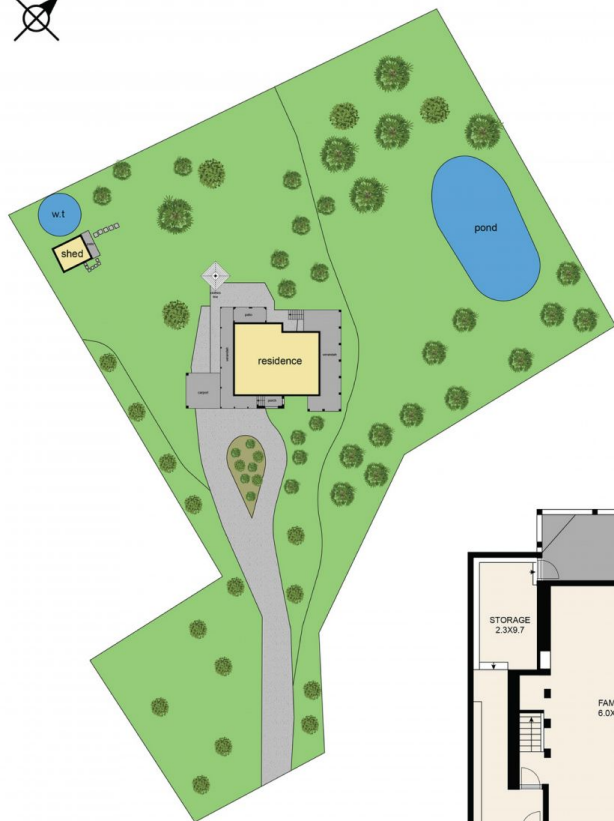

5 Gilba Place, Lilydale 3140

TOTAL APPROX. FLOOR AREA 267 SQ.M

Whilst every attempt has been made to ensure the accuracy of the floor plan contained here, measurements of doors, windows, rooms and any other items are approximate and no responsibility is taken for any error, omission, or misstatement. This plan is for illustrative purposes only and should be used as such by any prospective purchaser.