



69 West Bridge Road Glenburn VIC

4 2 8

Experience the essence of modern rural living in this captivating property situated on approximately an acre of scenic land. "Sambel" offers a seamless fusion of contemporary luxury and rustic charm, providing an ideal haven for you and your loved ones.

"Sambel" is a 3-year-old home boasting 4 sizable bedrooms, 3 with BIR and the master with WIR and ensuite along with shared bathroom designed to provide ample space and comfort for the entire family. Inside, you'll find floating hybrid timber floors and 10ft ceilings, creating a bright and airy ambiance throughout the home. Stay comfortable year-round with Reverse Cycle Air Conditioning (RCAC) and a charming Coonara wood fire.

Step outside and discover the enchanting large outdoor Alfresco area, perfect for entertaining guests while

Price : \$ 1,100,000
Land Size : 2232 sqm
View : <https://www.nobleknight.com.au/sale/vic/shepparton-central-north/glenburn/residential/house/7938626>



Anthony Knight
03 5797 2500



Megan Tiberi
03 9730 1788

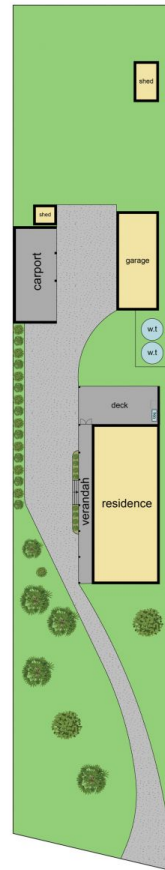

69 West Bridge Road, Glenburn 3717

TOTAL APPROX. FLOOR AREA 219 SQ.M

Whilst every attempt has been made to ensure the accuracy of the floor plan contained here, measurements of doors, windows, rooms and any other items are approximate and no responsibility is taken for any error, omission, or misstatement. This plan is for illustrative purposes only and should be used as such by any prospective purchaser.

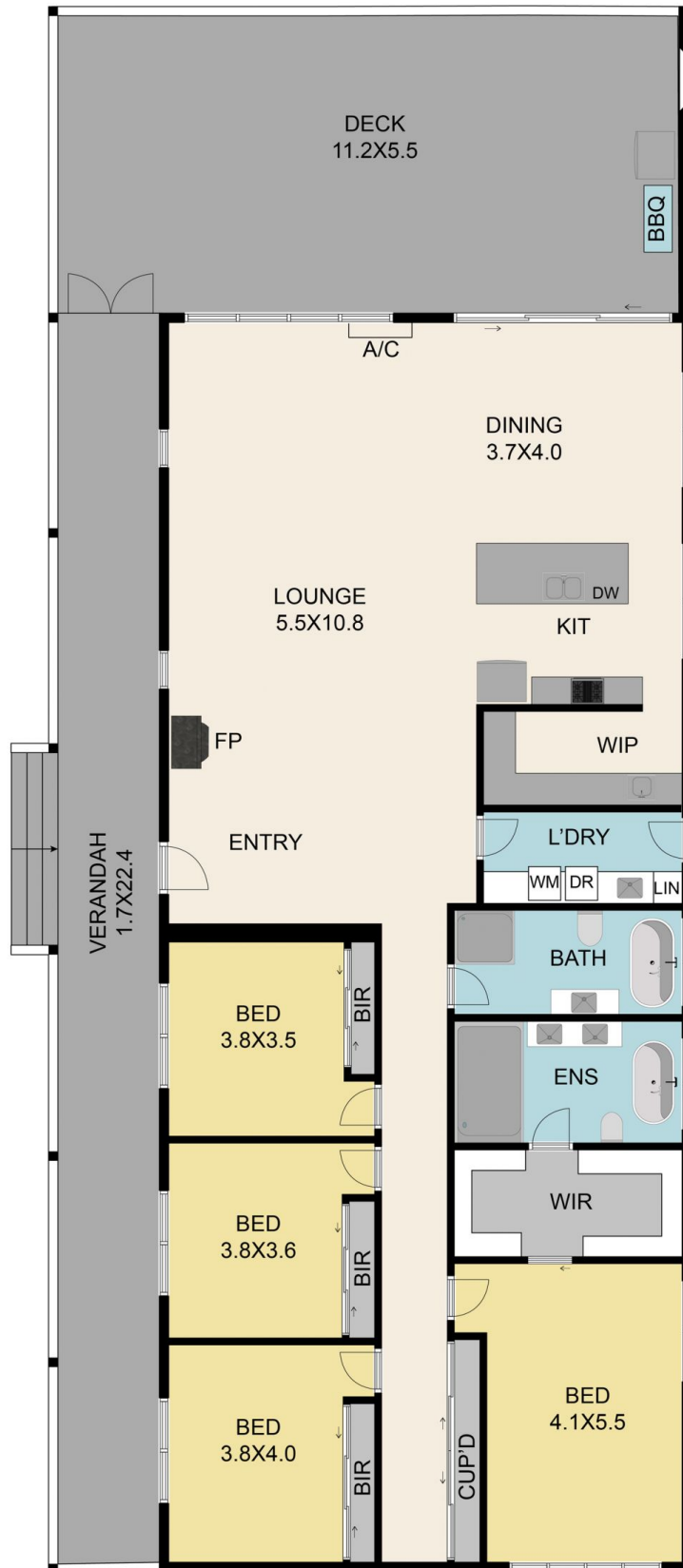

69 West Bridge Road, Glenburn 3717

TOTAL APPROX. FLOOR AREA 219 SQ.M

Whilst every attempt has been made to ensure the accuracy of the floor plan contained here, measurements of doors, windows, rooms and any other items are approximate and no responsibility is taken for any error, omission, or misstatement. This plan is for illustrative purposes only and should be used as such by any prospective purchaser.