

26 Melba Highway Yering VIC

6 🏠 4 🚗 5 🚗

Villa Raedward, set in two acres of stunning, mature, low maintenance garden, offers three architecturally designed separate dwellings; a grand, three-storey villa and two separate one bedroom residences approved for short-stay accommodation which is in high demand in the Yarra Valley. The Grand Villa is a luxurious palazzo style, with a pivotal 11- metre-high central void, offering enormous light and surrounded by staircase to access the four bedrooms and extraordinary bathrooms. Three of the main bedrooms are complete with their own balcony that each celebrate the magnificent views of the mountain range and rolling pastured fields. The main Villa features also include a study, two marble bathrooms, powder room, large kitchen with walk-in pantry, 3 additional separate living areas, a wine cellar and storage facility, enormous laundry and downstairs shower room, gymnasium, sizeable walk-in linen, and storage room, and a massive 12.5 x 7.1 garage

Price : \$2,450,000-\$2,600,000
Land Size : 8078 sqm
View : <https://www.nobleknight.com.au/sale/vic/yaradandenong-ranges/yering/residential/house/7862435>



Anthony Knight
03 5797 2500



Megan Tiberi
03 9730 1788



*The plan is for illustrative purposes only. Floor area is living space
All details to be confirmed on site.

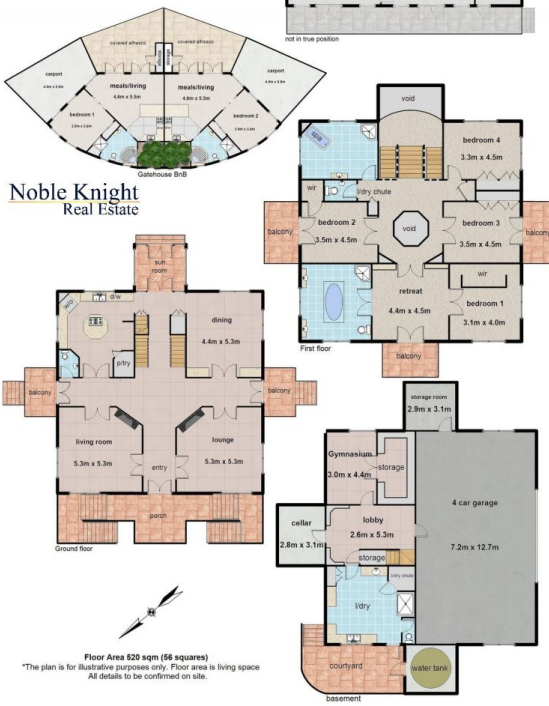

Floor Area 520 sqm (56 squares)
*The plan is for illustrative purposes only. Floor area is living space
All details to be confirmed on site.