



13 Hutchinson Street Lilydale VIC

Presenting an exceptional opportunity in the heart of Lilydale, this strategically positioned property, zoned Commercial 1, holds limitless potential. Its versatility allows for a myriad of possibilities, making it an ideal investment for astute developers and investors alike.

Situated in a prime location sat on 722sqm approx., this property offers the perfect canvas for a mixed-use development encompassing both commercial and residential components. While awaiting planning approvals or finalizing your vision, you have the option to lease out the shop or office space, ensuring a steady income stream by retaining the existing leases for the two factories on the premises.

Type	: Other
Price	: \$ 2,000,000
Building Size	: 394 sqm
Land Size	: 722 sqm
View	: https://www.nobleknight.com.au/sale/vic/east/lilydale/commercial/other/7746447



Damian Ford
03 9735 5677



Brad Knight
03 9730 1788

[For full version visit the website](https://www.nobleknight.com.au)

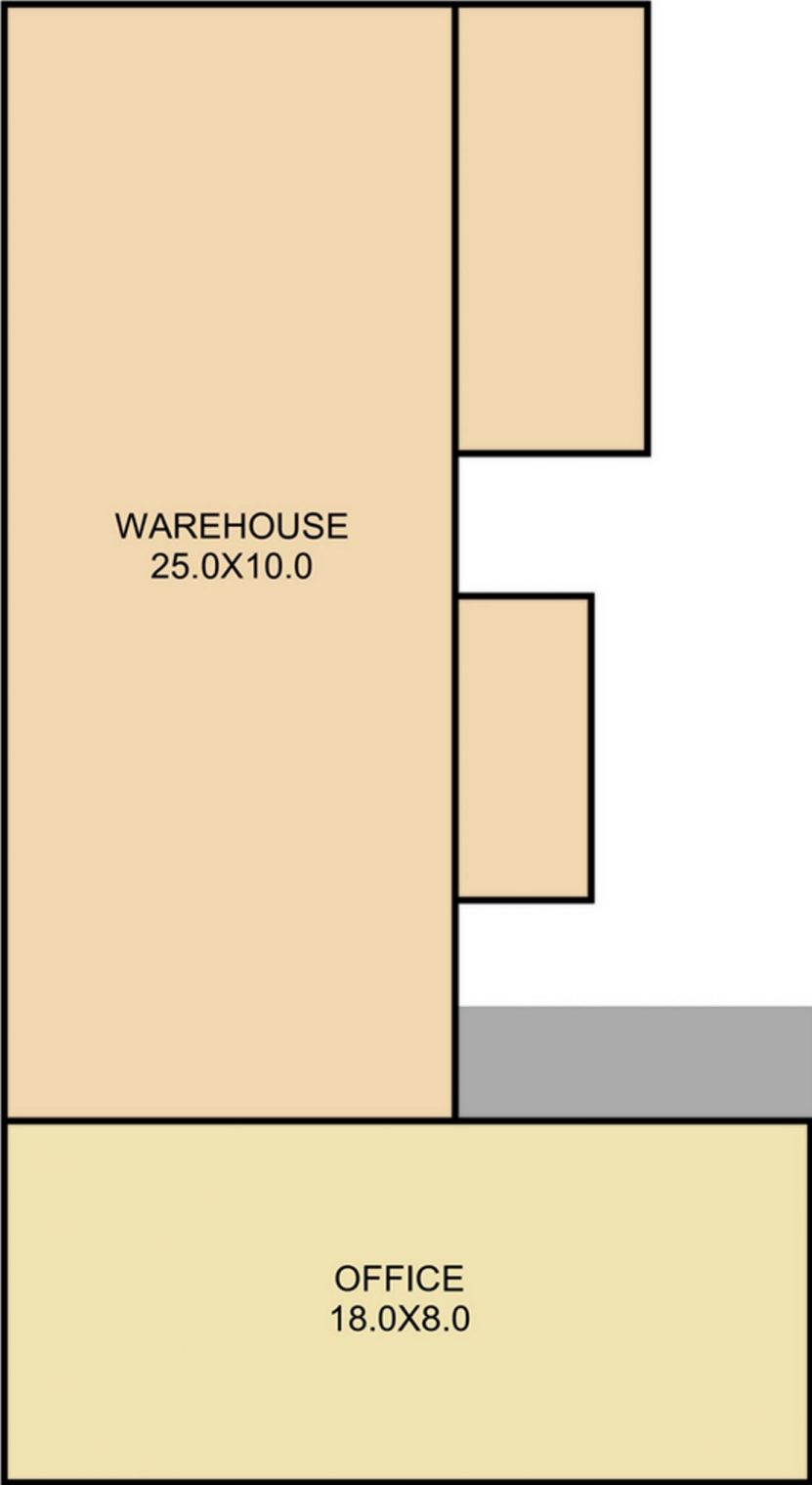

WAREHOUSE
25.0X10.0

OFFICE
18.0X8.0